

# AVON RIVER TEAM



## STONEHENGE DEANERY, DIOCESE OF SALISBURY TEAM PROFILE





## CONTENTS PAGE

Welcome and Introduction	3
Looking to the Future	3
Our Background	4
Where are we?	4
Role Description	5
Person Specification	5
The Ministry Team	6
Functioning as a team	6
What we do together	8
Schools	10
Individual parish profiles	11
Stonehenge Deanery	14
The Vicarage	15
Some Statistics	16

## WELCOME AND INTRODUCTION

A warm welcome from the Avon River Team. We are delighted that you have been drawn to read about us and we invite you to learn more about the Avon River Team and people (around 18,000 population) who live in this scenic part of rural South Wiltshire, close to the Stonehenge World Heritage Site. We hope that you are inspired to discover more about our Team and submit an application to work with us as Team Vicar (full time, stipendiary post).



## LOOKING TO THE FUTURE

We are looking for a new **Team Vicar** to help us in our call to *Make Jesus Known* to the whole community and strengthen our churches to grow and be a witness to the love of Christ - a priest who can be both incarnational in a rural setting, befriending people through village life, and yet also equipped with an apostolic, pioneering heart, seeking to reach young people and families through some of our schools.

As both a lay and ordained Staff Team, we are committed to working together and supporting each other to grow a **mixed ecology of worshipping communities across our seven parishes**, nurturing and energising our traditional worship services (BCP and CW) alongside other newer services: such as Breakfast Churches and “Fun Church”. We have a responsibility and calling especially to relate to those in our schools and the British Armed Forces.

We have discerned a need for the new Team Vicar to be **deeply rooted in their rural village context**, sharing their joys and sorrows and ups and downs, and being a dependable, approachable and caring priest: a friend to everyone. We are looking for a **keen sense of pastoral awareness** with an imagination to revitalise small congregations, all of whom are keen to grow. The new Team Vicar would have pastoral oversight of our four northern parishes, being first port of call for occasional offices, pastoral visiting and discipleship.

We would like the new Team Vicar **to bring their own gifts** to encourage prayer, discipleship and service to the wider community. We want a team player who will thrive within a group of gifted team members. At present our Staff Team is mutually accountable, under the guidance and oversight of our Team Rector, Rev Philip Bromiley. Philip has 26 years of parochial ministry experience, has recently trained two Assistant Curates, and is a Vocations Adviser and Ecumenical Adviser to the Bishop for Wiltshire.

A unique feature of our context is **the number of schools** within our boundaries. These are home to many military families living locally too and so form a fabulous intersection between church, army, new housing and families. Five schools are Church Schools and we have an independent school, two community primary schools, a soon to be built specialist school for children with SEN, and a Secondary School. The missional opportunities are endless! We would love the new Team Vicar to **help oversee this ministry** in terms of enabling us to continue to deliver Collective Worship, develop our Community Hub based in St. Michael’s Primary School, and come alongside our ecumenical “Open the Book” Team.

In order to release clergy from the burden of administration, we have a highly skilled **part time Administrator and a Team Office**, ensuring that fees are managed and dispensed, as well as organising wedding and funeral bookings, and the services rota. We would like the new Team Vicar not to feel tied to a computer, but to have as much time as they can to be amongst the parishes.

## OUR BACKGROUND

The Avon River Team (ART) was established in its present form in September 2011. Our communities are deeply rooted in the traditions of rural village and farming life. Many of the parishioners go back generations in the same village, and their families return for marriages, baptism of their children and funerals, sometimes from very far away. Durrington has more new estates and a much bigger, diverse and mobile population. At its heart however, there is still a core population of older residents who have raised families here, many of whom still live in the area. This is evidenced by the nature of the funerals we are asked to take.

In such strong local communities, with active village lives, our clergy feel very much owned by their parishes and have close involvement with all ages. This is a place where people put down roots - they come and stay if they can, and the military families who move round often return and retire here too. Salisbury Plain is an outstandingly beautiful area in which to live and work and, apart from occasional gunfire during training exercises on the Plain, is extremely peaceful and much enjoyed by residents and visitors.

British Forces withdrawal from Germany, a few years ago, has meant the development of two new housing estates and a significant growth of population in Larkhill and Bulford Garrisons. We have good pastoral and educational links between the Team and the military community. Army padres participate in Deanery Chapter, but are often away on deployment.



## WHERE ARE WE?

Over the hill from Stonehenge in Wiltshire, our parishes run northwards on the A345 from the Countess Road Roundabout on the A303. They lie up the valley of the River Avon, about 6 miles end to end, and there is access from the A345 and also from the minor road up the east side of the river.

It's about 80 miles eastwards to London and 80 miles westward to Exeter by car. Good train services east and west from Salisbury or Grateley, journey time to London is about 1 hr 20 minutes. Amesbury is just to the south of the A303 and has most everyday needs. Salisbury is 12 miles away with all the amenities of a Cathedral city – theatre, cinema, wide range of shops, excellent NHS hospital and a private hospital, a summer arts festival and lots of activity at the Cathedral. Andover, Devizes and Marlborough are alternative venues for arts and shopping. Salisbury has a boys and a girls grammar school, and there are other excellent schools in the area.



## ROLE DESCRIPTION

### Our priorities are:

- Being prayerful and Jesus centred
- Being committed to both the traditional and newer forms of worship
- Being intentional about our pastoral involvement in the local community
- Being a friend to our schools and nurturing faith in children

### The role of Team Vicar will involve:

- Being a personable team player
- Helping people to grow their faith through prayer and worship together
- Encouraging mission and growth in congregations
- Having an awareness of rural village life and the dynamics of the military community
- Building on the pastoral opportunities of baptisms, weddings and funerals
- Working closely with our Church of England Primary Schools, other schools and community
- Encouraging the parishes to work more co-operatively and to share resources

## PERSON SPECIFICATION

The new Team Vicar should be able to show the following gifts and skills:

### Spiritual leadership

- A depth of faith in the love of God and the power of the Holy Spirit demonstrated through lively preaching, communicating the Bible, dependence on prayer, and pastoral care for the communities

### Team member

- The ability to participate and inspire colleagues through faith and personal example
- The desire to enable lay pastoral care across the team

### Communicator

- A friendly, effective communicator with all sections of the community and age groups, from children in school to the elderly in the day centre
- The ability to join in and encourage parishioners further with the study of the Bible in a vibrant, relevant manner, with groups of all sizes

### Facilitator

- Willing to uphold both traditional and modern forms of worship, music and singing
- Ready to work with those who already lead worship and to encourage others to lead, deliver and participate in regular worship

### Organised

- Well organised, delegating duties as appropriate, and working with our Administrator
- Having a willingness to oversee and inspire volunteers to participate in schools work across the Team

### Creative

- To gain the trust of church members to take risks and engage with the wider community in Kingdom shaped ways



## THE MINISTRY TEAM

**Our Ministry Team comprises:** A Team Rector, a Team Vicar (stipendiary), a Team Priest, a Licensed Lay Minister, an Assistant Curate (third year), five Lay Worship Leaders, and five Lay Pastoral Assistants with various levels of regular involvement in ministry. There is also a Team Treasurer, a Team Administrator and a Safeguarding Officer.



## FUNCTIONING AS A TEAM

The geographical split between the parishes of the Team for pastoral care and oversight of PCCs is as follows:

**Team Rector:** Milston, Durrington, Bulford  
**Team Vicar:** Enford, Fittleton, Netheravon, Figheldean

## ARTC & PCCs

Our Team Ministry is structured with a Team Council providing strategic oversight in our overall mission and ministry, and seven PCCs who oversee the day to day running of the buildings and services in their local contexts. The delegation is as follows:

Team Level	Parish Level
Mission Initiatives	Distinctive Worship (Style)
Team Finances	Mechanics of Service
Team Events and Social	Fabric and Buildings
Collective Team Training (e.g. safeguarding)	Finances
Approving & Resourcing of Training	Nominations for Training
Resources for Services	Fundraising
Collective Buying	Events
Communications (including Website and Facebook)	Pastoral
Team Administration	

## Administration

**The Staff Team:** Priests and Lay Ministers, meet every Tuesday morning for an hour or so and are joined by a wider group every other week for Tuesday Morning Matters.

**Tuesday Morning Matters:** One representative from each parish, the Staff Team and the administrator have about 30 minutes to look at issues for the coming fortnight, and check through day-to-day diary events. This is also an opportunity to flag up any pastoral issues. Notes of this meeting are circulated to all churchwardens.

**Avon River Team Council:** Parish representatives, Team Treasurer and Staff Team, meet usually four times a year.

## Communication

**Parish Magazines** - Church volunteers in Durrington produce and distribute the *Durrington Dispatch*. *The Netheravon Newsletter* (for Netheravon and Fittleton), *Enford Parish Newsletter* and *Figheldean Parish Magazine* are all produced by the civil parishes, but contain a Rector/Team Vicar's letter and details of services. All publications are produced free of charge and delivered to every house in their area.

**Pew Sheet:** The Team publishes a weekly *Sunday Pew Sheet*, which is emailed to approximately 215 homes together with a Sermon for the Sunday and an activity sheet for children. Paper copies are available in church and are delivered to those without email connection.

**Website:** Core information is also seen on the *Website*, [www.avonriverteam.org.uk](http://www.avonriverteam.org.uk)

**Facebook:** we have an Avon River Team Group Page for news and publicity, posters etc.

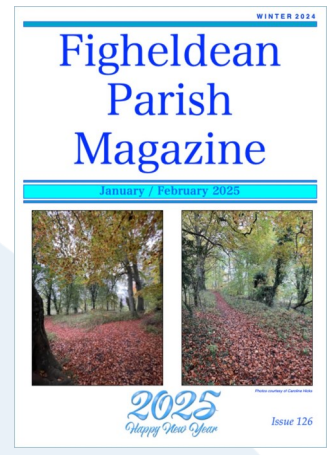
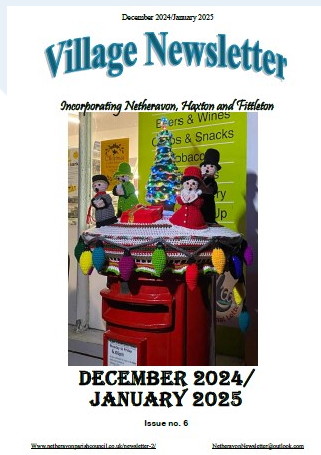

## Fabric and Finances

All parishes have risen to the challenge to generate funds to pay their Diocesan share and the daily costs to run their respective churches. For some this is a greater struggle than others and one or two have fallen short, but are working hard to recover. Fundraising events are a key method to bridge any shortfall and boost reserves.

## Military Presence

One of the distinct advantages of living in the villages of the Avon Valley is that we are surrounded by 90,000 acres of Salisbury Plain with its wonderful open views and unique chalk hills environment. We have access to the paths and tracks and appreciate that, while it is a military training area, this in itself acts as conservation for the landscape and wildlife.

The Army provides much employment for the civilian population, and there are significant resources and facilities which can also be accessed. Serving Army personnel who choose to live in our villages settle quickly and soon play an active part in the community, bringing multiple skills. Their children are absorbed into our schools and bring a delightful variety of experience from their previous postings. There are frequent pastoral opportunities for weddings and baptisms. Many who serve in the area choose to settle here permanently when they leave the forces.

## WHAT WE DO TOGETHER

The Parishes continue to maintain their own individual traditions and organise and run their own activities. However, in line with our expressed vision, there are now more frequent occasions when parishes come together for worship, fellowship and community building events.

### WORSHIP, PRAYER AND STUDY

#### Sunday Worship

Details of the current pattern can be found on the website. There is a service for each parish every Sunday except on the second Sunday of the month when we have a united team service. This service rotates round the parishes. Prayer ministry is offered after Team Services. Netheravon and Fittleton have been sharing services over the last few months and this is certainly something to develop and build on. Our weekly online service of Compline at 8.00 pm is attended by an average of 12 people.

#### Breakfast Church and Fun Church

Enford and Figcheldean each have a monthly Breakfast Church – an informal service led usually by lay people, with guitar accompaniment for singing and a hot breakfast is served. Both enjoy an attendance of 25/30 people. Fun Church in Durrington is also monthly – with a growing congregation of families and great potential for outreach (50/55 people).



#### Admission of Children to Communion before Confirmation

Approval has been given by all seven PCCs for children to receive Communion. Developing children's nurture and confirmations is certainly an opportunity in the future.

#### Weekdays

Two weekday services of Holy Communion are held, one in Durrington, the other in Bulford, with an average attendance of 8 to 12 people.



#### Service orders

The team has a Common Worship order of service for all seasons of the year, and an order containing Book of Common Prayer Holy Communion, Matins and Evensong. Service orders have also been produced by the team for other occasions.

#### Music

We are fortunate to have a pool of volunteer organists, and also guitarists for the more informal services. In the absence of an organist all churches have the facility to use pre-recorded hymns on a CD.

#### Bells

There is a ringing team in Durrington, and another which covers the towers in Enford, Fittleton and Netheravon.





## **Lent and Advent**

Seasonal Bible study sessions or a series of visiting speakers are organised on a Team basis for Advent and Lent.

## **Prayer and discipleship**

There is a long established Health and Wholeness prayer group meeting monthly, and there are regular opportunities for prayer, through lay led home groups, a monthly listening prayer hour, and prayer partnerships. A prayer list with names of those sick or bereaved is also published in the weekly pew sheet.

## **Ecumenical contacts**

There are Methodist, Baptist and Roman Catholic churches in Amesbury, and we have regular contacts with them through such occasions as the World Day of Prayer. Relationships between Durrington Community Church and our Team are strong. We hold walk of witness events, and share Men's breakfasts. There are some newer churches emerging (Nigerian and Fijian) that tend to meet in Village Halls.



## **PASTORAL, OUTREACH AND FELLOWSHIP**

### **Lay Pastoral Assistants**

Following Covid we lost many LPAs for a variety of reasons. This ministry is now in a process of revisioning and redevelopment.

### **Home Communion**

Clergy or LPAs take Home Communion to the sick and elderly as requested. We have no care homes in our Team.

### **The 2<sup>nd</sup> St Leonards Scout troop**

The Scout troop attends Bulford Church once a month for the family service. They are also very supportive of various fund raising activities for the church.

### **Lent lunches**

Simple weekly soup lunches are held informally at venues across the seven parishes, supporting Christian Aid.

### **Open the Book**

A group goes into two of our schools. With more volunteers this ecumenical ministry could be developed.

### **Fresh Expressions**

We have two monthly Breakfast Churches. The one in Enford attracts families and children and is coordinated by clergy and lay team. The one in Figheldean attracts older people and is entirely lay led.

### **Foodbank**

A group of volunteers responded to the financial crisis after the pandemic to work with Salisbury Foodbank and establish a Foodbank in Durrington to serve the local villages. This is now ecumenical and is to evolve into a Food Pantry in the future. All of our churches have boxes to collect food for the foodbank.

### **Marriage Preparation**

Couples with weddings booked in our churches meet their officiating priest and, when possible, attend a marriage preparation session as a group. We have a wedding venue in our Team (Syrencot House) and we provide a welcome for couples wishing to have a church wedding prior to their wedding reception.





## COMMUNITY ENGAGEMENT

### Coffee mornings

Church members support six local coffee mornings held regularly in the villages, midweek and on Saturdays.

### Knifty Knitters

This knitting group meeting in Bulford church makes various items for sale and for gifts, and also assembles gift shoe boxes at Christmas for the Food Bank. The group knits “Prayer Bears” as gifts for children to be baptised.

### Day Centres

The Day Centres for the elderly are well supported by church members in Netheravon, Durrington and Bulford. There is also a monthly Monday Lunch Club in Figheldean.



## SCHOOLS

### Collective Worship and Foundation Governors

The team has close contact with the CofE Primary Schools in Bulford Village, Larkhill and Netheravon and the CofE Junior School and Infant School in Durrington, (all part of the Acorn Education Trust) as well as the independent prep school (Avondale) in Bulford Village.

The Team has church representatives on the governing bodies of the CofE schools and assistance is provided weekly for their collective worship.

There is also a secondary school in Durrington (Avon Valley College/Acorn Education Trust), and army garrison primary schools in both Larkhill and Bulford camps. Engaging further with schools will be an important part of the new Team Vicar’s role.

### New School Build

In 2018 St Michael’s CofE Primary School moved from Figheldean into a brand new building on an estate on the edge of Larkhill Garrison. There are now 420 children on roll with 17 different nationalities, reflecting the diversity of the British Army. To promote community cohesion, our Curate has been heading up a Community Hub, called Star Club. It meets after school on a Thursday, every other week, and welcomes children and families into the school library for tea, crumpets, activities, and music. It is funded by the Team. We continue to have a presence on the Advisory Board (Governing body) and conduct Collective Worship weekly.

### The Old School, Figheldean

The premises stood empty for some time before the decision was made by Wiltshire Council to commission a special school to be developed by the Outcomes First Group. Extensive renovation and extension is now in progress for the opening expected in Spring 2025. The school will be a day school for primary children with special educational needs and will be a welcome addition to the life of the village community.



## INDIVIDUAL PROFILES SUBMITTED BY THE SEVEN PARISHES

*Listed north to south as shown on the cover map – a journey of approximately six miles*

**ENFORD** Parish Church is an integral part of the Enford community, enjoyed for social gatherings like the Christmas Fayre, Christmas tree lighting, choral concerts, weddings and a chaps keep-fit club! Our small but faithful congregation consists of a combination of military, non-military and ex-military families who regularly attend a variety of monthly services including our popular Breakfast Church and a recent pet service! Music for services is a combination of the organ, CD and guitar depending on what is available or appropriate.

The village has a well-equipped village hall and field which is used regularly for wedding receptions, private parties and clubs like: Film, Gardening, Pilates and Football; including our annual Summer Fête and Bonfire night. And not least, we boast an excellent pub - the Swan - popular for food, Friday night gatherings and a bi-weekly coffee morning.

As a Church we long to grow in number and reach out to the whole village by providing meaningful and welcoming services.



**FITTLETON CUM HAXTON** is a small village situated about one mile north of Netheravon, with a mix of privately owned and social houses. It shares many amenities with Netheravon. There is a good community spirit in the village. The PCC of six is industrious and active in its fund-raising efforts to support the church and to pay its Parish Share; events include coffee mornings (some in church), summer fêtes, harvest suppers and quizzes. Many events also serve as outreach to embrace the wider community. The church warmly welcomes all to its services and other activities.

The Church is considered important to many in the community. The congregation is mainly middle to retirement age and above. There are only a few families with young children.

There is a strong historical link to Netheravon's C of E Primary school (now with Academy status) and also the Netheravon Phoenix Hall, which is managed by Fittleton and Netheravon Parish Councils. The village newsletter (produced for 10 months of the year) is where church services, fundraising events and local notices are advertised. It has a circulation of 800 copies.

**NETHERAVON** is a vibrant and thriving village that offers a wide range of amenities and a strong sense of community. The village is home to a convenience store with a post office and off-licence, a pub, a volunteer-run library, a family brewery, a hairdressing salon, a village hall, a working men's club, and various local businesses including electrical, plumbing, and decorating services. Many of the parishioners are or have been employed by the Ministry of Defence (MOD), either as serving personnel or as civil servants at nearby MOD establishments.

All Saint's Church has Saxon origins and is the largest church in the Avon Valley Team. Like many parishes across the CofE, the congregation has dwindled in recent years and is now formed of a relatively small core (6-12), plus occasional visitors. The church building sits on the outskirts of the village, and this often seems like a metaphor for how it is viewed by the community more widely. The PCC are seeking a new vicar to forge stronger links into the village, and to harness significant latent interest from a large military community, a thriving school community, and a bustling village full of people keen to have a greater sense of community.



The attractive vicarage sits in the centre of the village and with the right incumbent there is the opportunity to lead a rejuvenation, increasing awareness, contact and church footfall. All Saints could once again be described as a lynchpin in the pattern of community life, presenting the good news of Jesus in a lively, relevant and engaging way.

Members of the congregation are actively involved in various village bodies and activities. These include the parish council, the volunteer-run library, the village hall management, the working men's club, and a day centre that supports 18 elderly people from the wider community. The congregation also participates in the Jubilee Committee, which disburses funds to support village events and activities, and they serve as school governors as well as participating in wider village events such as street parties to mark significant national occasions.

**FIGHELDEAN** is a small peaceful village with a friendly population of approximately 600. The church of St Michael and All Angels holds regular services, some of which have a special theme to encourage the non-regular church attendees and new members.



There is also a monthly Breakfast Church which attracts a regular mix of both churchgoers and non-churchgoers- a busy local community event. The church has a toilet and kitchenette which gives scope for other events to take place within the building. We are able to organise concerts etc as the church has added flexibility since the pews were replaced with chairs in the 1950's. PCC members are active in a significant number of areas which include, village hall committee, the Wholeness and Healing Group, Avon and Bourne Valley Art

Exhibition and links with other denominations within the Team's parishes and adjacent areas.

There is also a Brambles Pre School established in the adjoining hamlet of Ablington and a thriving Book Club with members from both villages. The impressive modern village hall and recreation ground are well used for sports and social events plus wedding receptions, a weekly coffee morning, a monthly Lunch Club.

Annual events such as The Figgfest and the Avon and Bourne Valley Art Exhibition attract people from nearby areas, both of which support local charities. The village has a working men's club which provides additional social events and hosts an annual Tree of Light event which is supported by many villagers and all donations go to our church. A group from across the team takes part in the Sponsored Bike Ride for the Wiltshire Historic Churches Fund. Netheravon Airfield Camp is within the Figheldean parish boundary, and is the home of the Army Parachute School. Free fall parachuting is a regular no cost entertainment!

**MILSTON WITH BRIGMERSTON** is the smallest of the parishes in the Avon River Team as is the church building itself. The hamlets of Milston and Brigmerston have some 50 dwellings and a population of around 170. The church seats 40 comfortably and up to 80 with a squeeze! There are 18 active church members as defined as our Worshipping Community. Furthermore church attendance has been pleasingly stable, with an average attendance of 16 at the two monthly services of Holy Communion.

The church is kept open at all times and as evidenced by the comments in the visitors' book, it attracts many visitors who appreciate its simplicity, the beauty of its holiness, and the tranquillity of the rural setting. Milston's most famous son, the poet and essayist Joseph Addison, born across the road from the church, described the view from the porch across the water meadows in his famous hymn based on Psalm 23:

"To fertile vales and dewy meads,  
My weary wandering steps he leads.  
Where peaceful rivers, soft and slow,  
Amid the verdant landscape flow."



St Mary's Milston is well known for its enthusiasm for all things traditional. It is a corporate member of the Prayer Book Society and has three mid-morning services a month – two Holy Communions and one Matins, all from the Book of Common Prayer. It would like to become the church of choice for prayer book services for the rest of the Avon River Team and indeed for all the parishes in and around Salisbury Plain. The church is well known for the friendliness of its welcome, its long-standing and united PCC, its enthusiastic singing and, last but not least, the high standard of its flower arrangements.

**DURRINGTON** is the largest village in the team, with a Town Council. The Army garrison of Larkhill is within the parish boundary. The village has a leisure centre with a gym and swimming pool, a fitness centre, dance studio, a working men's club, two pubs, along with a number of locally run clubs which include the Durrington Community Choir, a short mat bowls club, a badminton club and the WI. There are a number of small shops including a Tesco metro, a NISA and a Sainsbury's small supermarket, a chemist, a car repair garage and fuel station. It is also well served with a chippy, kebab shop, two cafes, two Chinese takeaways and one Indian restaurant and takeaway. Most local needs are catered for along with a veterinary surgery and a doctor's surgery in both Durrington itself and in Larkhill. There is also a post office at the NISA supermarket and a library housed within the Village hall.



The church building dates from Norman times celebrating its 900th anniversary in 2025. The church has a well maintained organ, a bell ringing team and the benefit of gas central heating. There are a number of ongoing projects corresponding with the anniversary that include the provision of a new kitchen and children's area, roof and bell tower maintenance and repair. There is also a small church hall that houses the Avon River Team Administration Office, the Durrington Food Pantry and a number of craft and bible study groups, in addition to the Team Staff and administration meetings.



**BULFORD** is the most southerly Team parish and adjacent to the large army camp which is included in the parish boundary. There is one smaller military establishment within the village. The church is run by an active and enthusiastic PCC. There is an active 'Knifty Knitter' group which meets in the Camilla Hall, (a hall converted from the old north transept/vestry.)

The Church supports the Food Bank, runs coffee mornings for the locals and has links with the village Free Church, the working men's club and the local army cadets.

During the year St Leonard's runs the usual fundraising events to keep abreast of the 'share'. These include social evenings, summer fete (*pictured*), jumble sales and the Christmas fayre.

The Church has strong ties with the Bulford 2<sup>nd</sup> (St Leonard's) Scout Group. Although they draw their support from across the Team area, the troop has adopted St Leonard's as their anchor church. Their newly built HQ hut is close to the church. The troop (cubs, beavers and the scouts) regularly attend the monthly family service and willingly assist at church events.

## STONEHENGE DEANERY

The Deanery encompasses 23 parishes, in a range of single parish benefices, teams, and single parishes. As a Chapter (clergy and LLMs) we meet monthly, using a programme we create together annually. The themes under discussion are wide ranging, and enhance the excellent Diocesan CMD provision. We also value highly the opportunity for fellowship, monthly worship, and social events which Chapter brings.

It is an expectation in this diocese that all stipendiary clergy will be an active part of their chapter, and we have found this to be a hugely beneficial part of our shared ministry in this place. Membership of chapter is also regarded as an opportunity to pool experience and resources; that we might best serve the communities in which we live, and grow individually as members of God's kingdom. We look forward to welcoming another member into the Chapter.

Deanery Synod tries to focus on matters pertinent to all parishes. In the past year we have explored how we might re-invigorate our links with South Sudan, and the needs of the elderly in our parishes. This deanery is almost unique in the concentration of Armed Forces' personnel, either those who are currently serving and who live here, or their families who have settled here, and those who have served and retired here. We extend an invitation to attend Chapter to all local Padres and value the experience they bring to our meetings.



## THE VICARAGE

The Vicarage is set in the heart of the beautiful village of Netheravon and is close to local amenities, including the pub, coffee shop and village shop. It is a good sized family house with a study, downstairs cloakroom, 2 reception rooms and a kitchen with a utility room. Upstairs there is a bathroom with separate WC and 4 bedrooms. It is heated by a kerosene boiler. There is good parking at the front for off road parking and a single garage. A large secluded back garden is laid out to grass, fruit trees and shrubs. There is a small area of vegetable garden.

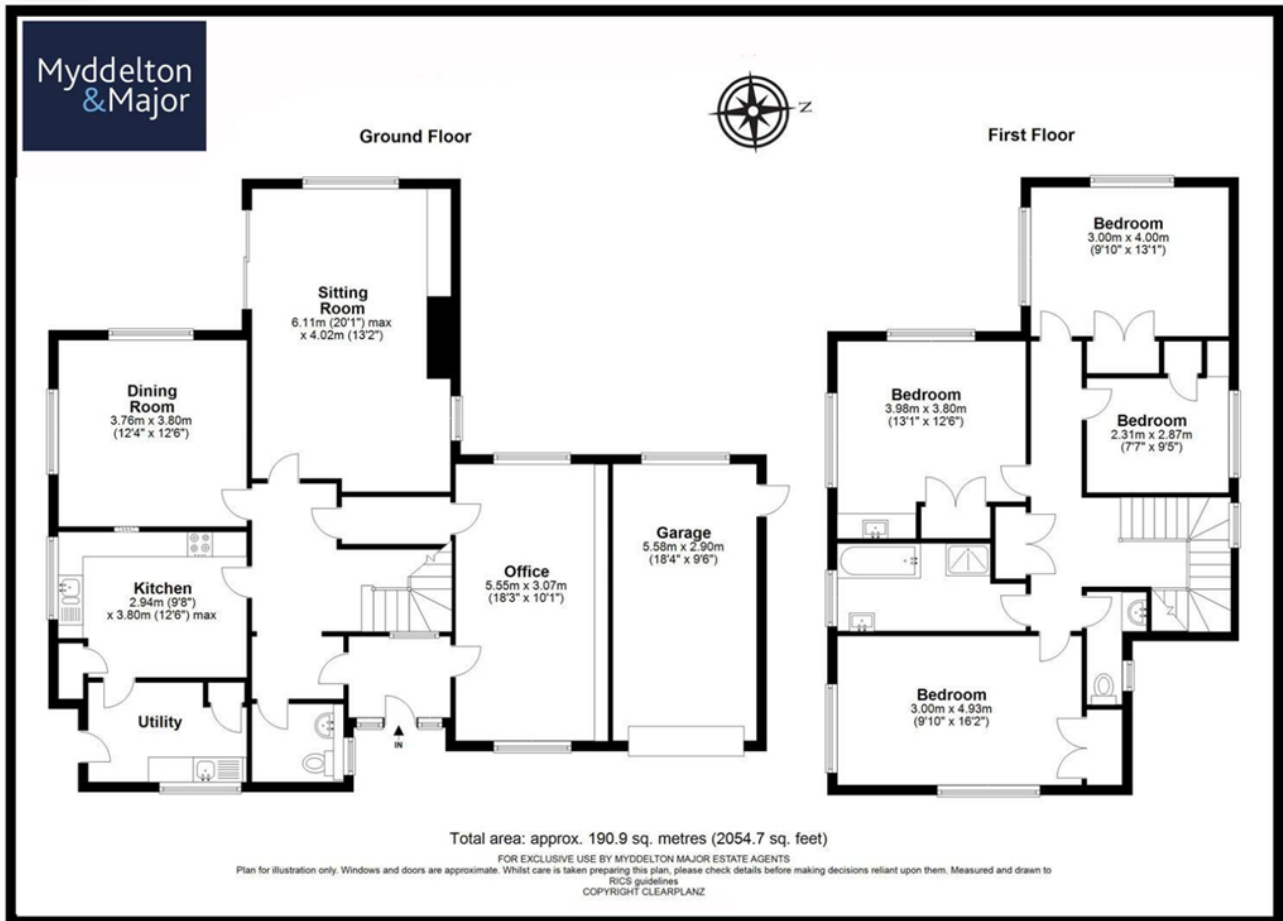

AVON RIVER TEAM

Parish Share to Salisbury DBF 2024

Enford	Fittleton	Netheravon	Figheledean	Milston	Durrington	Bulford	Total
£15,308	£10,736	£15,664	£11,487	£13,718	£21,472	£10,850	£99,770

Baptisms, weddings and funerals 2024

	Enford	Fittleton	Netheravon	Figheledean	Milston	Durrington	Bulford	Total
<i>Baptisms</i>	2	2	4	0	2	18	7	35
<i>Weddings</i>	5	0	0	0	1	1	1	8
<i>Funerals and Interments</i>	6	4	2	7	4	28	13	64



Praying Churches, Serving Communities